

Vicon Product Range





Enter the World of Vicon

Strong Product Offering Being a high-profile specialist, Vicon offers dedicated products and services within forage harvesting equipment, round balers, soil cultivation, seeding systems, fertiliser spreaders and sprayers. In addition Vicon holds a leading position within ISOBUS machines and solutions. Accurate and cost-efficient implements and harvesting systems ensure high quality results and clean forage and feed.





Precision Farming There is no doubt that precision farming represents the future of the agricultural industry and this is a trend farmers will increasingly embrace and profit from. Kverneland Group's concept within precision farming, iM Farming describes and presents our offering of ISOBUS machines and solutions for electronic steering, all aimed at giving an insight into the benefits and efficiency of our extensive offering.

Global Partner The Kverneland Group is characterized by both global coverage and strong local presence, with Vicon products being offered in more than 60 countries worldwide and with sales companies in another 17 countries. The Kverneland Group consists of 11 manufacturing sites, each acting as dedicated competence centres with manufacturing, R&D and product management closely linked together.



Disc and Drum Mowers

No Compromises: 3 Bladed Discs for Better Cutting Performance!



With a working width of 2.80-3.20m and an operating weight of only 670-710kg, the EXTRA 328F-332F requires as little as 45hp to operate. Outstanding ground following ability, easy operation and low weight are among the highlights of this machine.



The EXTRA 300 range boast a wide working range of 2.80-4.00m. With weights of 810-940kg, power requirements start at 50hp. EXTRA 300 range features vertical transport position, centre suspension, NonStop BreakAway and the new hydraulic setting of ground pressure.



The EXTRA 100 series machines are offered in working widths of 1.70, 2.20 and 2.40m, and are designed around the well-proven, fully welded EXTRA cutterbar, providing effective and reliable performance.



The EXTRA Cutterbar

The EXTRA cutterbar is designed for low maintenance and offers a very quiet operation. Operators will immediately love the virtually quiet operation of the new cutterbar - convenient during a long and busy working day. Viccon's counter-rotating three bladed discs provide a wider overlap, ensuring a perfect cut.

EXTRA 332XF is the first front disc mower with an actively driven swath former, designed for both narrow swathing and wide spreading. With the option of 3 different swath widths (1.00m, 1.15m and 1.30m) and wide spreading up to 2.20m, this machine offers exactly the flexibility that most farmers are looking for. Changing between different swath widths is intuitively done in very little time – no tools required.





EXTRA Δ 390-395 plain disc mower butterfly is a combination that provides efficient performance with 8.70m or 9.50m working width paired with a low weight design, with power requirement starting as low as 120hp.



EXPERT 432F front mounted drum mower with 3.05m working width. Gentle ground contour following and excellent cutting quality are among the highlights of this model.



The range of trailed plain disc mowers, EXTRA Δ 500, in working widths of 3.20m and 4.00m, with low power requirement and fuel consumption, is based on a responsive flotation system with a sideward adaption of 17°, which provides excellent ground contour following.



The EXTRA Δ 200 series with low noise EXTRA Δ cutterbar, very flexible suspension, NonStop BreakAway and working widths of 2.80m and 3.20m.



The EXTRA Δ 432H and 440H with centre suspension and hydraulic setting of ground pressure. Working widths of 3.20m and 4.00m.



EXTRA Δ 624T, 628T and 632T Farmer compact mower conditioners with 2.40m, 2.80m and 3.20m working width and centre suspension. The mowers are folded into an above vertical transport position for stable transport and can be optionally fitted with hydraulic setting of ground pressure.



EXTRA Δ 632T Pro with 3.20m working width, hydraulic suspension, two speed gearbox and SemiSwing steel tine conditioning.



EXTRA Δ 690T ISOBUS is Vicon's top-of-the-line mower conditioner combination with ISOBUS control, where control and operation is designed around the tractor driver. It offers 9m working width and consists of a 3.20m or 3.50m front mounted and two 3.20m rear mounted mower conditioner units.



New Vicon EXTRA Δ 900 series, available in working widths from 2.40-4.00m. With an array of modular configurations, including BX-belt and FlipOver widespreading - the possibilities are endless.

Rotary Tedders

Oilbath Gearbox for Minimum Maintenance



The ProLine Gearbox

The gearbox of the Fanex tedders requires no maintenance, and is situated in an enclosed oilbath, set up to ensure constant lubrication. Compared to open gearboxes, where loss of lubrication increases at the end of each service interval, the wear and tear of the high performance tedders is kept at a constantly low level.

The new Vicon Fanex 764 is designed to perform perfectly in all crop conditions, with a minimum of non-productive maintenance required and with diminished transport dimensions. It is a 7.60m, 6-rotor tedder, fitted with 7 tine arms per rotor. Featuring a heavy-duty fully closed headstock this machine will fit perfectly into the operation of professional farmers, looking for a strong, effective, and versatile tedder.

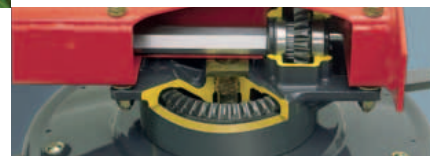



The CompactLine Fanex 604 with 6.05m working width and low maintenance gearbox.



Easy and convenient transport with the Fanex 1134T with transport carrier – an ideal solution for use with smaller tractors.



Fanex 834T with 8.30m working width combines high performance with low power requirements.



The new CompactLine Fanex 804 tedder with 8.05m working width is optimized for working with dry crop.



Fanex 683 and 903 are very reliable and well-proven mounted tedders with 6.80 and 9.00m working width and ProLine gearbox.



Fanex 763C and 903C with transport running gear are ideal solutions for use with low horsepower tractors. Still they offer 7.60m and 9.00m working width.



Fanex 1404C with 10 rotors and 13.30m working width offers top level tedding performance along with easy operation.



Fanex 1103C is an easily operated 8 rotor machine. It offers 11m working width and a transport carrier for safe and faster transport.

Rotary Rakes

Precision and Performance with TerraLink Quattro



The Robust Centre Part

The CompactLine rakes feature oilimmersed cam discs and guide rollers. Also, the tine arm bearings are fully lubricated, and hence absolutely maintenance-free. The ProLine rakes feature a unique drive system, which comprises oilimmersed pinion and crown wheels. The fully enclosed design ensures permanent lubrication, and makes the system absolutely maintenance-free.

The all new Andex 1254 by Vicor is designed to make lighter work of tough conditions and boosts raking capacity with its 12.50m working width. It masters high capacity and easy operation by focusing on the elements that really matter.





Single rotor rakes with working widths from 3.20-4.60m and curved tine arms for cleaner raking performance and swath formation. Available with both CompactLine and ProLine gearboxes.



Index 714T VARIO side delivery rake is fitted with the patented SideShift system to move the complete machine sideways in relation to the tractor – convenient when raking along border lines.



Index 774 is a heavy duty side delivery rake that is able to collect crop from a total of 14.50m into one swath.



Index 694 with a 6.90m working width offers all the exciting details like TerraLink Quattro, sturdy main frame and 12 tine arms per rotor. The VARIO execution offers the possibility to form two smaller swaths.



Index 724 and 764 CompactLine centre swath rakes with hydraulically adjustable working widths of 7.20m to 7.80m include actively steered wheels and TerraLink Quattro system. Index 724 is available as Hydro version with reduced transport height.



Index 804 and 844 are heavy duty centre swath rakes with 8.00m and 8.40m working width. Working width can be adjusted hydraulically from the cab to suit working and swath width. Index 804 with go below 4.00m transport height, even with all tine arms mounted.



Index 904 Hydro with adjustable working width of 8.00-9.00m. Due to the Hydro axle it has a transport height of less than 4.00m, even without detaching the tine arms.



Index 1104 twin rotor rake with 11.00m working width and hydraulically adjustable working/swath width and rotor height. The maintenance-free TerraLink system gives superb ground following of the rotors.



Index 1504 4 rotor rake with adjustable working width between 9.50-15.00m. Fully ISONUS compliant for easy plug-and-play, without the need for a separate terminal.

Transport and Loader Wagons

Power Up: Maximum Capacity and Cutting Quality



Pick-Up

The new MaxiFlow pick-up features a hydraulic driveline with centre pivot suspension of the entire pick-up unit that offers transverse adaptation of +/- 100mm. Other features are auto-reverse for easy unblocking and overload protection.



The Rotex Combi 700-703 and 800-803 are truly dual-purpose wagons, ideal for use as both loader wagon and silage wagon. They offer a high number of features like the new innovative MaxiFlow pick-up system with hydraulic driveline, ISOBUS control system, spring loaded boogie axles and largely dimensioned chain-and-slat conveyor.



The Rotex Combi 700-703 dual purpose wagon offers a loading capacity up to 72.8m³.



With a capacity of 40m³ (14 tonnes), the Rotex 400 model is designed for those with smaller, lower powered tractors, looking for compact wagon.



Providing a capacity of up to 55m³ and a laden weight of 20 tonnes, Rotex 550 is a rotor loader wagon that brings titanic dimensions to forage harvesting.



The T-Rex series is recognised by massive capacity, large loading volume and high discharge speed. Capacity of 40-45-50-55m³ respectively and a loading capacity between 24 and 34 tonnes.



The T-Rex Shuttle with a loading capacity of 30.5m³ is the efficient link between the forager and trucks for long distance transport.



The Alpex 220 and Alpex 280 are compact loader wagons designed to work well in hilly conditions, in small and narrow fields and also for municipal operations.



The Vicon Feedex 422 offers a loading volume of up to 44m³. The wagon is available with discharge rollers and a new side delivery conveyor belt. Vicon Feedex 440 offers the same high performance, but without discharge rollers and conveyor belt.



Vicon Duplex 400 and 600 are fast acting silage spreaders. With an enormous capacity, they easily and efficiently process the large amounts of silage.

Round Balers and Bale Wrappers

High Competence in Making Top Quality Bales



Intelligent Density 3D

The bale chamber of the RV 5216 and RV 5220 is designed for multi-crop use, and is equally at home in silage, hay and straw. With the new Intelligent Density 3D setting of bale density is made very easily with 3 preselected options for straw, hay and silage, all easily set from the control box.

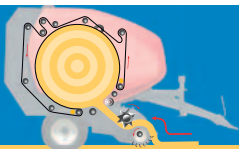

The RV 5216 and RV 5220 feature new patented net and twine wrapping and a new software package for easy selection of bale density. Intelligent Density 3D allows you to choose the bale density that is best for your crop conditions. Available with bale diameters from 0.60m up to 1.65m and 2.00m.



The RF 4225 fixed chamber baler is the ideal solution for both wet and dry conditions. The combined RotaMax bale chamber concept, with rollers at the front and chain and slat at the rear is the ideal combination for dense and well-shaped bales in all conditions.



The RF 4325 full roller fixed chamber baler is a high specification model developed for intensive professional use. The PowerMax bale chamber with 17 ribbed rollers is a truly wet silage specialist for well-shaped and tight bales.



The RV 5116 and RV 5118 feature everything you need to get the job done, including new Powerbind net and twine binding systems. The bale chamber can be set to operate with two different bale densities: soft or moderate cores.



The new FlexiWrap baler-wrapper combination with unique wrapping table for fast and accurate bale transfer. It can be paired with either the RF 4325 fixed chamber baler unit or the RV 5216 or RV 5220 variable chamber balers.



The BW 2250 allows you to wrap on the move. Pick up one bale and wrap it as you move to the storage site. It provides easy and gentle self-loading of the bales.



BW 2400, self-loading trailed turntable wrapper for easy operation. The maximum bale weight is 1200kg.



The BW 2600 is capable of handling bales up to 1400kg and the strong design allows a second bale of up to 1000kg to be carried on the loading arm, whilst the first is being wrapped.



BW 2850, high capacity satellite wrapper with two pre-stretchers for high speed. The maximum bale weight is 1400kg.

Fertiliser Spreaders

A Complete Range of Pendulum and Disc Spreaders



Download the spreading charts application from the App Store or Google Play Store. Exact advice at any working width, application rate and driving speed also available via www.viconspreadingcharts.com



The Vicon Spreader Competence Centre is using the most modern technology, allowing the measurement of complete overlap patterns in 3D. The 3D spreading pattern is achieved using a spreader which is mounted on the test rig which rotates the machine through 280°.



The RO-EDW GEOspread is a weighing spreader with integrated section control (24 sections) to provide optimal use of nutrients to your crops. The RO-EDW GEOspread can be operated with the IsoMatch Tellus GO or IsoMatch Tellus Terminal.



The RotaFlow Principle

The name RotaFlow describes the Vicon spreading system; the fertiliser granules are already rotating when they reach the spreading vanes. This initial smooth acceleration of the fertiliser prevents fragmentation of the granules due to impact with the vanes and maintains the spreading characteristics of the material.



The RO-M GEOspread is the new precision spreader which is ideal for the medium sized segment of arable and professional dairy farms. The GEOspread system makes it possible to adjust the working width and application rate individually for both discs, simply and accurately directly from the tractor cab, just by touching the ISOBUS terminal! The working width of the Vicon RO-M GEOspread system is divided into small 2 metre sections (max. 14 sections). The sections can even be switched inside-out and outside-in to keep overlaps to the minimum.



The RO-C is the most compact spreader in the twin disc range. Three different hopper capacities are available: 700, 900 and 1400 litres. Possible working widths: 9-18m (20/21m optional).



The master in the medium segment is the RO-M spreader. Available hopper capacities are 1100, 1550 or 2000 litres. The FlowPilot on each spreading disc has simplified accurate setting and adjustment. Working width from 10-24m (27/28m optional) are possible with this model.



The RO-M EW (EasyWeigh) makes spreading profitable for everybody. Standard equipped as ISOBUS compatible spreader. The Vicon reference sensor gives you absolute accuracy, because every kilo counts. Save costs and increase quality. Spreading the Easy Way!



The RO-XL is a high capacity spreader. The basic hopper capacity of 1500/1875 litres can be increased up to 3450 or even 3900 litres. Easy setting and adjustment with the FlowPilot. Spreading width: 12-54m. Also available mounted on a trailer.



The RO-EDW is our high tech weighing spreader. The hopper capacity of 1500 and 1875 litres can be increased up to 3450 or even 3900 litre hopper capacity. Working widths from 12-54m are possible. Utmost spreading accuracy is ensured by the unique reference sensor. All negative influences are automatically corrected and eliminated.



The RO-M and the RO-XL can be executed with the Comfort Control II control box. The operating panel provides to start and stop, the spreader to set the right application rate and to increase or decrease the application rate.



The PS225/335 pendulum spreader is ideal for use on sport fields and grounds. The PS225 has a hard wearing Poly-Ethylene (PE) hopper with a basic capacity of 200 litres and with an optional extension rim 330 litres hopper volume can be created. Spreading widths: 1-15m.



The PS403/503 spreaders, with 400 or 500 litres hopper capacity, are ideal for sand and salt spreading. Also available as VITI model, with only 115cm hopper width, especially designed for orchards. Spreading widths from 1-15m are possible.



The PS04 series consists of hopper capacities from 600 up to even 1650 litres and working widths from 1-15m. This versatile model is popular to use in vineyards, golf courses and general farm applications.

Harrows & Cultivators

Soil Preparation at its Best!



The Compactiller L/LF is a lighter execution of the Compactiller range for more shallow use from 3m to 6m mounted. This machine is for farmers who want to use the compact disc harrow up to 10cm deep. Consequently, the machine is 15% lighter, easier to lift, ideal to reduce the soil compaction and more economic for farmers. The frames have been designed to carry the heaviest roller like the Discpacker. A new disc arm receiving the heat treated disc of 520x5mm – (hardness 200kg/mm²). The arm cover avoids any lateral movement during work for a constant cutting quality. This disc hub is maintenance-free and for a long life time under large pressure at high working speed. The working depth is very easy to adjust by pivoting spacers according to the required depth. If the full roller weight is required, there is just one action on the hydraulic necessary! Simple, friendly and efficient! For a nice levelling on the edge, the soil flow is controlled by lateral deflectors. A finger harrow can be fitted in between. The Compactiller L range can be combined with Airsem SB.



The semi-mounted short disc harrow Compactiller T (4-7m) for high output with maximum comfort. Strong frame and front gage wheels give high stability without any jumping and a nice following of the ground contour. In transport the hydr. suspension ensures smooth run with highest security.



The mounted rigid Compactiller is available in 3m, 3.50m and 4m working width. The working depth is easy to adjust with the hydraulic depth adjustment.



Available from 4 to 6m, the Compactiller F is really easy to lift even with the heaviest roller thanks to the compact design. In transport position, the transport width is limited to 2.75m.



X-SEM 4 for intensive preparation for light to medium soils. Available in 3.00m, 3.50m and 4.00m. The new cage roller is related to carry all seed drills.



The Cultimat is our multi purpose cultivator for large farms and contractors. The equipment possibilities are as versatile as your demands.



The Cultimat (4 no. of rows) is available in working widths from 4.50m to 6.10m, the Cultimat Pro (5 no. of rows) from 6.10m to 9.10m.



The Discotiller XR is a heavy-duty disc harrow for optimum performance, durability and minimum operating costs. The robust 200x300x10 frame ensures machine stability. The special arrangement of the offset disc gangs guarantees perfect results over the full working width. Available from 3.60m (30 discs) to 6.30m (54 discs).



The seedbed cultivator Combimat has been designed to offer you a flexible machine that fits to all different soil conditions. This robust and modular cultivator can resort to a lot of equipment possibilities. Available in 4.00m, 5.00m and 6.00m.

Harrows & Cultivators

Soil Preparation at its Best!



KNOCK-ON

Knock-on is the easiest way of changing parts on a cultivator, either to adapt the machine to work or to change wearing parts. This user friendly system is able to work from 3 down to 35cm in a very economic way in regards to the low pulling requirement and the cost of the parts which is at same level as the standard points. Just 10 seconds to exchange one share!



The Vicon Rau cultivator range is providing a large choice of equipments enabling to adapt the Tinetiller R rigid or foldable to a shallow stubbling mode of 5cm or to a deep cultivation at 35cm depth. It's 3 row tine arrangement is particularly efficient in incorporating and well dispatching large amount of residues thanks to a very high under beam clearance of 870mm. In combination with levelling disc and active rollers like the Discpacker, Rimpacker and Rimflex the Tinetiller is a multi task cultivator able to prepare fine seedbeds.





The Flextiller T has been developed for shallow cultivation from 3cm to 15cm deep thanks to the Flexline. The tine pitch of 19 cm ensures a full cut at shallow depth. Available in 6.5m and 8m working width.



The Terra PL is a single-beam subsoiler available in 3 or 4m working width. The single-beam concept provides a very robust design, allowing an underbeam clearance of 1,175mm to guarantee operation without jamming, at depths from 15 to 40cm.



The Airsem SB has been designed to establish cover crops while stubbling, but as well other crops like rape, grass, etc.... in order to save time and energy cost. Two models are available depending of the seed rate/ha and the output of the machine with 200 and 500l hopper capacity.



The Tinetiller L was designed as a cheaper and lighter alternative to the Tinetiller R, getting only levelling tines based on simple arms for 3.00-3.50m rigid and 4.00m, 4.50m and 5.00m fold available. This lighter design is enabling the Tinetiller L to be handled by tractors from 90hp.



Tinetiller Cut built on Tinetiller L concept with 1 row of cutting disc and 2 row of tines. In this configuration the machine is able to work with high amount of residue without any blockages. Tinetiller Cut is available in 3m and 3.50m rigid and 4m and 4.50m fold.



The Tinetiller Trailed (4.00m to 6.00m; for tractors up to 400hp) has a very strong frame which can get either 3 or 4 rows of tines. All tine variants (Shear bolt or Non Stop) and their arrangement ensure blockage free operation with big clearance between the beams (up to 1500mm) and under beam.

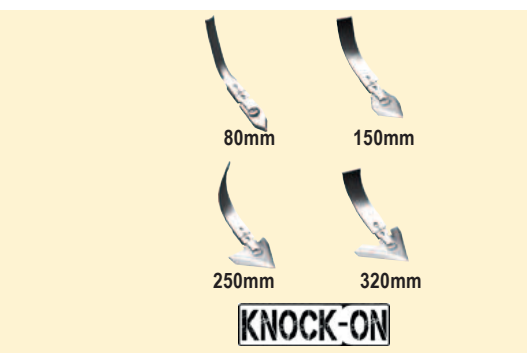

The Knock-on range is full of possibilities offering 6 widths of cutting with 80, 150, 250, 320mm shares and 345mm Quantum share to match with various tine spacings and depths required.

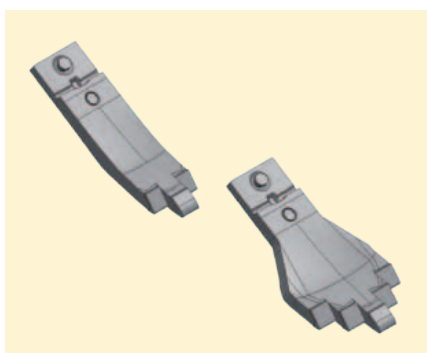

2 carbide points are proposed together with the Knock-on deflectors: The Tiger point 80mm and 150mm. Their special design makes the point penetrating in the hardest soil. Their lifetime is extremely long due to the carbide design used combined with extremely sturdy steel.



Vicon cultivators can be equipped as an option with the 345mm Quantum share for hard soils. It is always combined with Knock-on 80mm or Tiger point 80mm.

Choppers & Power Harrows

Professional Chopper Range for all Conditions!



New Chopper Bromex PA

Vicon renew light chopper model suitable for green area and grass maintenance operations. Bromex PA got compact frame round shaped and it is very easy to operate requiring very limited maintenance. Rotor with density blades and high rotation speed (1993 rpm) permit accurate cut. Working widths 1.2 to 1.8m up to 50hp tractors.



The Bromex Mplus and Bromex M is a multipurpose chopper for road maintenance, field edges, ditches and hedges. It also shows versatility in grass, light wood and bushes thus being ideal for the maintenance of parks, gardens and road sides. For tractors from 100 to 150hp. Bromex M 1.55m, 1.85m and 2m and Bromex Mplus 2m and 2.30m working width.



The Bromex CFX offer wider working capacity (5.60m) but very narrow transport width (2.50m). It's ideal choice for chopping maize, sunflower, set aside stubble. Great performances ensured by 2 large rotor and high reliability given by double lateral transmission For tractors up to 260hp.



The PM is a compact heavy duty machine for moderate jobs in soft and top fruit orchards, vineyards and light undergrowth. Equally perfect for tidying pasture and other grass fields, and chopping straw and stubble. Suitable up to 80hp and available from 1.55m to 2.50m.



The Bromex PF is a versatile chopper, available in 2.35m, 2.80m and 3.25m working width. A strong double headstock allows mounting the machine in front or behind the tractor. Together with the hydraulic offset it is a multi-purpose chopper for nearly all conditions.



The Bromex PXD and PX are versatile machines suitable for front and rear tractor mounting. Hydraulic offset (54/52cm) contribute in making PXD and PX very efficient in all working conditions. Excellence cutting quality. Available in 2.35m and 3.20m working widths.



The Bromex CX range comprises our largest and toughest grass and straw choppers for heavy-duty work on set-aside land and cultivated fields. Suitable for tractors up to 160hp. Working widths 1.95m, 2.35m, 2.80m and 3.20m.



The Bromex CZ chopper clearly focuses on huge and intensive farms; it is ideal for very demanding and specialized contractors. The CZ is excellent for shredding crop residues, chopping straw, maize and sunflower stalks as well as set-aside land. Suitable up to 260hp, working width from 3.20m to 4.00m.



The backbone of the Vicor power harrows is the strong trough design, conceived to provide cost effective operation in the toughest conditions. Assured durability has been achieved by the use of widely spaced, large diameter taper roller bearings. These are combined with hardened gears and a strong self supporting gearbox trough. The Toptiller TT19 (up to 190hp) and TT25 (up to 250hp) are equipped with quick-fit tines. The quick-fit tines can be quickly replaced without the use of tools ensuring minimum down time and maximum productivity. The Toptiller TT15 (up to 150hp) is equipped with bolted tines as standard, while quick-fit tines can be supplied as option.



The foldable power harrow TT-F20 (4 and 5m working width) is a light machine for solo use and for tractors up to 200hp. The TT-F30 and TT-F35 are available in working widths from 4 to 6m. It offers the possibility to attach a seed drill coulters bar or a precision drill by means of the optionally available hydrolift.

Seeding Equipment

Perfect Seeding Solutions for Optimising Your Profits!



Depth adjustment

The depth adjustment, carried out without using any tools. For level even ground it can be set in the rigid position, in cloddy or stony conditions its is set in the flexible position to ensure smooth running, finally in extreme wet conditions the press wheel can be lifted out of work completely. On slightly sticky soils an optional scraper is recommended.



CX-II coulters – The newly developed CX-II disc coulters combine the advantages of the former CX coulters with the latest research results and customer feedback. The new CX-II coulters are precise, and very easy to set up. It guarantees smooth running and requires less power to pull than the original CX. The shallower cutting angle of the steel disc requires less coulters pressure to reach a constant seeding depth of up to 6cm. The flat profile disc has a cutting angle of only 5.4° which makes the coulters very easy to pull, thus reducing the power requirement. Smooth operation is ensured when working at high working speeds and large quantities of plant residues on the soil surface. The coulters CX-II are completely maintenance-free!



The Vicon Mecasem XTC is the favourite cultivator mounted mechanical seed drill with hopper volumes up to 820 l. CX seed coulter are available.



The Airsem L is the lightweight cultivator mounted pneumatic seed drill for combination with power harrows and tine cultivators. Available in 2.50m and 3m working width. The standard machine is equipped with a 1000rpm V-belt drive. It can optionally also be supplied with a hydraulic drive.



The Airsem XTC is the heavy-duty version of the Vicon Rau seed drills and is available in working widths from 2.50m to 4m. This seed drill has been designed for applications demanding high performance, e.g. for the professional farmer and contractor. A wide range of coulter are available: Suffolk-, CX- and CX-II seed coulter.



The Airsem FT is our solution for modular seeding. With a front hopper for seed or fertilizer and a rear mounted rigid or fold coulter bar. Available from 3m to 6m working width. Hopper content from 1,150 l to 2,200 l (with an optional hopper extension).



Multicorn DP II – Universal precision drill. The optimum choice for maize, beans, sunflowers and other seed types, for standard and mulch seeding. The Multicorn DP II available from 3m to 9m, with infinitely adjustable row widths and a wide range of additional equipment. New! Multicorn V with variable telescopic frame.



Unicorn, the mechanical precision seed drill for sowing pelleted beet seed. With its 6 to 24 row unit configuration, the Unicorn easily copes with varying operating conditions. Of special note are the parallelogram design and the frame construction, which is as robust as it is variable.

THE FUTURE OF FARMING IS IN PRECISION FARMING

iM FARMING

There is no doubt that Precision Farming represents the future of the agricultural industry and this is a trend that farmers will increasingly embrace and profit from. Advanced tractor technologies coupled with adoption of GPS have led to development of highly efficient and productive machinery that can perform multiple tasks.

The goal: high efficiency, reducing costs and increasing crop quality and yield. It should provide better protection for the environment and improve working conditions for farmers in terms of enhanced safety, comfort and convenience. And farmers will increasingly have at their disposal a wealth of real-time data from which they can draw to make important management decisions on their farm and monitor their production progress.

iM FARMING describes and presents our offering on ISOBUS machines and solutions for electronic steering, all aimed at giving an insight into the benefits and efficiency of our extensive offering.

As a farmer you demand a lot from your machines. It must be tuned to your vision and lead to a more efficient way of working. Kverneland Group helps you to choose the solutions to suit your farming requirements.



facebook.com/iMFarming



[@iM_Farming](https://twitter.com/iM_Farming)



youtube.com/kvernelandgrp



iM FARMING

smart efficient easy **FARMING**

- Our total offering is explained in 4 steps, from the basic ISOBUS machine up to advanced high-end solutions in Precision Farming:

iM Ready



Investing in a machine with ISOBUS technology is the first step towards convenience, greater accuracy and enhanced efficiency.



iM inControl



Solutions where you have control over the ISOBUS machine via an IsoMatch Tellus or IsoMatch Tellus GO terminal, machine control functions and additional control accessories such as a camera.



iM Global



Solutions whereby the ISOBUS machine is controlled by GPS and IsoMatch GEOcontrol on the IsoMatch Tellus, IsoMatch Tellus GO, or tractor terminal.



iM Intelligent



Intelligent hardware installed on the machine in combination with a universal terminal for the highest level of precision and efficiency and ultimately profitability.



Always inControl with the IsoMatch Tellus

Using ISOBUS as the interface, the IsoMatch Tellus can communicate with all ISOBUS machines and is equipped to work with GPS positioning systems.

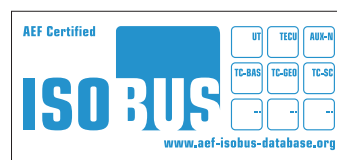

The easy-to-use touch screen is designed for ease of use whatever the task. You have an excellent view of the two screens, to control the performance of the implement, while using and monitoring other applications such as IsoMatch GEOcontrol.



ISOMATCH TELLUS – THE ADVANTAGES

- More ease and overview in the cabin
- One terminal to control all implements
- Two screens, more possibilities to control functions
- Data saving for learning and accountancy
- Great base for further functionalities, like GPS
- More efficiency, savings on input such as fertiliser or seed
- Expand the possibilities with IsoMatch accessories
- Always ahead with the latest developments

New

ISOMATCH TELLUS GO

Kverneland Group is extending its range of Universal ISOBUS Terminals with the IsoMatch Tellus GO. This new multifunctional one-screen terminal is developed for fast and simple control of any ISOBUS implement, giving the farmer a 'custom made' experience as it suits all needs for plain and efficient handling of farming machinery and tasks.

First step into Precision Farming

IsoMatch Tellus GO is the farmers first step into Precision Farming. With the easy to use application, IsoMatch GEOcontrol, it is possible to boost efficiency and save time and costs. The application includes Manual Guidance, Section Control and Variable Rate. Whether it is used with fertiliser spreaders, sprayers or seed drills, Precision Farming is just one click away.



iM FARMING
smart efficient easy **FARMING**

Made for efficient farmers



iM inControl with Tellus GO

THE NEW ISOMATCH **TELLUS GO** TERMINAL OFFERS YOU **FAST AND SIMPLE CONTROL** OF YOUR ISOBUS MACHINES, GIVING A **PLAIN AND EFFICIENT** HANDLING OF ALL FARMING MACHINERY AND TASKS. ON TOP, WITH ITS **EASY TO USE** PRECISION FARMING APPLICATIONS, YOU WILL **SAVE TIME AND COSTS**. **WORK EASY. BE IN CONTROL. TELLUS GO.**

MORE INFORMATION: TELLUSGO.KVERNELANDGROUP.COM

NEW!
isoMatch
Tellus GO



Tools & Accessories:

Make your IsoMatch Terminal even



Supporting farmers anywhere, any time

You can allow your dealer, sales company or factory direct access to the terminal and machines via Wi-Fi. They have complete access to your machine and are able to solve the problem as if they were on site without the need to travel. You are not wasting precious time by waiting on a solution and can go back to work.

This functionality is part of the IsoMatch TopService a professional service application for Kverneland Group's electronic products to provide diagnostics and software update capabilities in addition to many other advanced features.



Maximum efficiency with precision farming

IsoMatch GEOcontrol for use with fertiliser spreaders, sprayers, seed drills and precision drills, can boost accuracy and efficiency, while allowing seamless integration with precision farming systems.

IsoMatch GEOcontrol provides the following functionalities:

- Automatic section control
- Variable rate control
- Documentation
- Manual guidance
- Headland control
- Smart boundary recording

This advanced software application installed on the IsoMatch Tellus or IsoMatch Tellus GO, makes it possible to automatically switch the implement's sections on/off. It is a simple job, especially during night operations. You can use variable rates by downloading field maps to the Terminal which is then controlled by GPS. The savings are significant on input costs such as fertiliser, chemicals and seeds.



Virtual implement connection

Wondering how an IsoMatch Tellus or IsoMatch Tellus GO is working in practice with ISOBUS implements?

With the help of the IsoMatch InDemo plug, your dealer can easily show you, even without an implement or tractor.



n more complete

IsoMatch[®] Simulator

E-learning for Precision Farming

The IsoMatch Simulator is an easy PC application to demonstrate the use of the IsoMatch Tellus and IsoMatch Tellus GO, Kverneland Group machines and Precision Farming functionalities such as Section Control and Variable Rate.

It simulates the full functions of the IsoMatch Terminals and ISOBUS machines. There is even a GPS system included as if you are using it in the actual field. This makes it easy to learn and practice with all the functions before using the actual product.

Scan QR code to discover the IsoMatch Simulator and download it for free!



Discover more of our service and demonstration tools. Scan QR-code to watch the animation video.



Always ahead with the latest developments

Once you have made the investment of an IsoMatch Terminal, you are on track with the latest technology. Kverneland Group guarantees support and updates in the years to come.

No worries about outdated technology and information on your screen or of non-compatible software. Customers who purchase an IsoMatch Tellus or IsoMatch Tellus GO are ensured free updates of new developments. Additionally, we inform you about the latest news and trends in our world of agriculture.

ISOMATCH INLINE Light bar for manual guidance



The IsoMatch InLine is a light bar which allows easy manual guidance. It is the perfect assistant to get you as close as possible to your desired A-B line. The display of the IsoMatch InLine also displays the status of the machine sections.

ISOMATCH GLOBAL Antenna to GPS signal

The essential accessory for IsoMatch GEOcontrol is the IsoMatch Global GPS antenna, with DGPS accuracy. It enables satellite navigation for site-specific section control, variable rate application and field registration.



ISOMATCH MULTI-EYE For better view by day and night



You can connect up to four IsoMatch Eye cameras and easily switch between the cameras with the remote control box which is standard included.

ISOMATCH WIRELESS USB for internet connection

The IsoMatch Wireless makes it easy to connect the IsoMatch Tellus to a local wireless network, such as your phone's hot-spot, home network etc. No additional costs of an internet service provider.





Original Parts
We Keep Your Machine Running!



ORIGINAL PARTS & SERVICE

THE KEY TO KEEPING YOUR MACHINE RUNNING!

Every Farmer has to deal with a constant set of variables. Ever-changing weather conditions, fluctuating markets and new laws, all contribute to a demanding workload. This is precisely why you need machinery you can rely on. And this is why you should invest in Vicon.

Our machines are engineered to a high standard, guaranteeing you maximum efficiency whatever the conditions. Combine our technology with our state-of-the-art factories, our extensive distribution and dealer network, plus our substantial investment in R&D, and the result is a many layered back-up helping you maximise efficiency and productivity. Vicon customers aren't just buying a machine. They're establishing a relationship with a resourceful partner who's been innovating farming since 1879.

“Our Dealers are quite literally our men-in-the-field, helping us to help you.”

DEALERS

Our Dealers are quite literally our men-in-the-field, helping us to help you. Like our machines they are boringly reliable. They are always on call, and they will always find the right solution for you. And when things do finally wear out, your local dealer will either have the necessary parts in stock, or can obtain them within 24

hrs. He will also have the facilities to service your machines, ensuring that they're always running optimally. It's always worth keeping in touch with your dealer, not just for updates, but also because he will often be featuring promotions, offering deals that you simply won't get elsewhere. He'll even give you a cup of coffee.

ORIGINAL PARTS

Innovation and reliability go hand-in-hand with quality. Original parts from Vicon are designed and manufactured to a uniformly high standard, ensuring the reliability of your machine, and

guaranteeing that you'll always achieve the results as promised.

Yes, there are cheaper parts out there, but tests have also indicated that these cheaper parts are inferior to ours. It's a false economy saving money on spares that have increased wear and decreased efficiency. In the long run they only cost you more money and time; especially if they also affect your machine warranty.

Original parts will always work and fit as intended, and are guaranteed to keep your machine running optimally.





Kverneland Group

Kverneland Group is a leading international company developing, producing and distributing agricultural machinery and services.

Strong focus on innovation allows us to provide a unique and broad product range with high quality. Kverneland Group offers an extensive package aimed at the professional farming community, covering the areas of soil preparation, seeding, forage and bale equipment, spreading, spraying and electronic solutions for agricultural tractors and machinery.



Original Spare Parts

Kverneland Group spare parts are designed to give reliable, safe and optimal machinery performance - whilst ensuring a low cost life-cycle. High quality standards are achieved by using innovative production methods and patented processes in all our production sites.

Kverneland Group has a very professional network of partners to support you with service, technical knowledge and genuine parts. To assist our partners, we provide high quality spare parts and an efficient spare parts distribution worldwide.

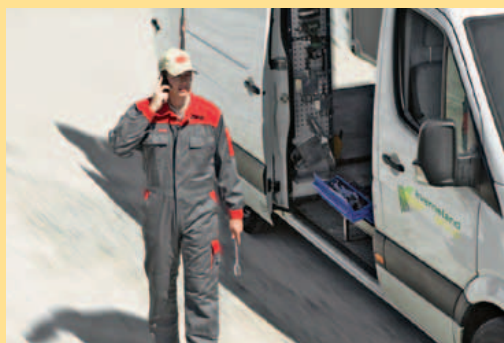

 **Watch us on YouTube**
www.youtube.com/kvernelandgrp

 **Like us on facebook**
 KvernelandGroup
 iMFarming

 **Follow us on Twitter**
 @KvernelandGroup
 @iM_Farming